



Pojemnościowy



## Digital Signage Player - Wall Mounted - Android 49 inch MobiPad HDY490W

<b>Category:</b>	Digital Signage Displays
<b>Manufacturer:</b>	Mobilator
<b>Supported OS:</b>	Android
<b>Installed OS:</b>	Android 7.1.2
<b>Screen size:</b>	49"
<b>Resolution:</b>	3840 x 2160
<b>Aspect ratio:</b>	16:9
<b>Brightness:</b>	500cd/m <sup>2</sup>
<b>Touchscreen:</b>	Capacitive, 10-Point
<b>CPU:</b>	Quad Core ARM Cortex A9 1.6GHz RK3188Quad Mali 400 533Mhz (Mali400MP4)
<b>RAM:</b>	2GB DDR3
<b>Flash memory:</b>	16GB
<b>Temp:</b>	0°C - 50°C
<b>Storage Temp:</b>	-20°C - 60°C
<b>Humidity:</b>	10% - 95%
<b>Others:</b>	----
<b>Power:</b>	AC 100V 240V 50/60Hz
<b>LAN:</b>	RJ45, 10M/100M BaseT

<b>3G:</b>	Available in other configuration
<b>Bluetooth:</b>	No
<b>Connectors:</b>	Mini USB (OTG), SD (max. 32GB), RJ-45, 2x USB 2.0, HDMI, DC
<b>Camera:</b>	No
<b>Speakers:</b>	2 x 5W
<b>Expansion:</b>	----
<b>Mounting VESA:</b>	Optional
<b>Folding Bracket:</b>	No
<b>Contrast Ratio:</b>	1200:1
<b>Viewing Angle:</b>	89°/89°/89°/89°
<b>Color Resolution:</b>	----
<b>Housing material:</b>	Metal / Aluminium
<b>Dimensions:</b>	1170mm x 690mm x 55mm
<b>Weight:</b>	----

**2 882,81 zł**

net price: 2 343,75 zł





The concept of Digital Signage includes an integrated form of system management, which includes electronic displays (digital signs, infosics) that present information, advertising, and other messages. Digital signage systems are used, inter alia, at airports, points of sale or service networks (eg travel companies, real estate, information, stations, shopping centers, etc.).

## SPECIFICATION

[go top...](#)

<b>Processor</b>	Quad Core ARM Cortex A9 1.6GHz RK3188
<b>Operating system</b>	Android 7.1.2
<b>RAM</b>	2GB DDR3
<b>Flash memory</b>	16GB
<b>Display</b>	49" IPS   3840 x 2160   16:9
<b>Touch</b>	Capacitive, 10-Point / Infrared Touch

<b>Brightness</b>	500cd/m <sup>2</sup>
<b>Contrast</b>	1200:1
<b>Communication</b>	Wi-Fi   3G (option)
<b>Interfaces</b>	Slot SD   HDMI   USB 2.0   Mini USB (OTG)   RJ-45
<b>Dimensions</b>	1785mm x 630mm x 45mm
<b>Weight</b>	42.7kg
<b>Storage temperature</b>	-20°C - 60°C
<b>Work temperature</b>	0°C - 50°C
<b>Humidity</b>	10 - 95%

## DESCRIPTION

[go top...](#)



Multi-tasking

Thanks to the latest technology, the panel computer is designed for continuous multi-tasking operation with low power consumption. An important advantage is the efficient combination of small dimensions with great capabilities through the use of Arm Cortex A9 processors and 2GB of memory. Integrated video and audio systems allow you to play a wide range of applications and media files (video, audio). 8GB of flash memory is available.



**Durable**

The panel housing of 1785mm x 630mm x 45mm was made from the highest quality plastic, which provides very high resistance to mechanical damage. This model, weighing only 42.7kg, is ready to operate at any time, even under severe conditions such as heat or cold. Digital Singage Player - Android 49 Inch Touch PanelPC MobiPad HDY490W is a series of devices designed for demanding applications - 24 hours a day, 7 days a week.

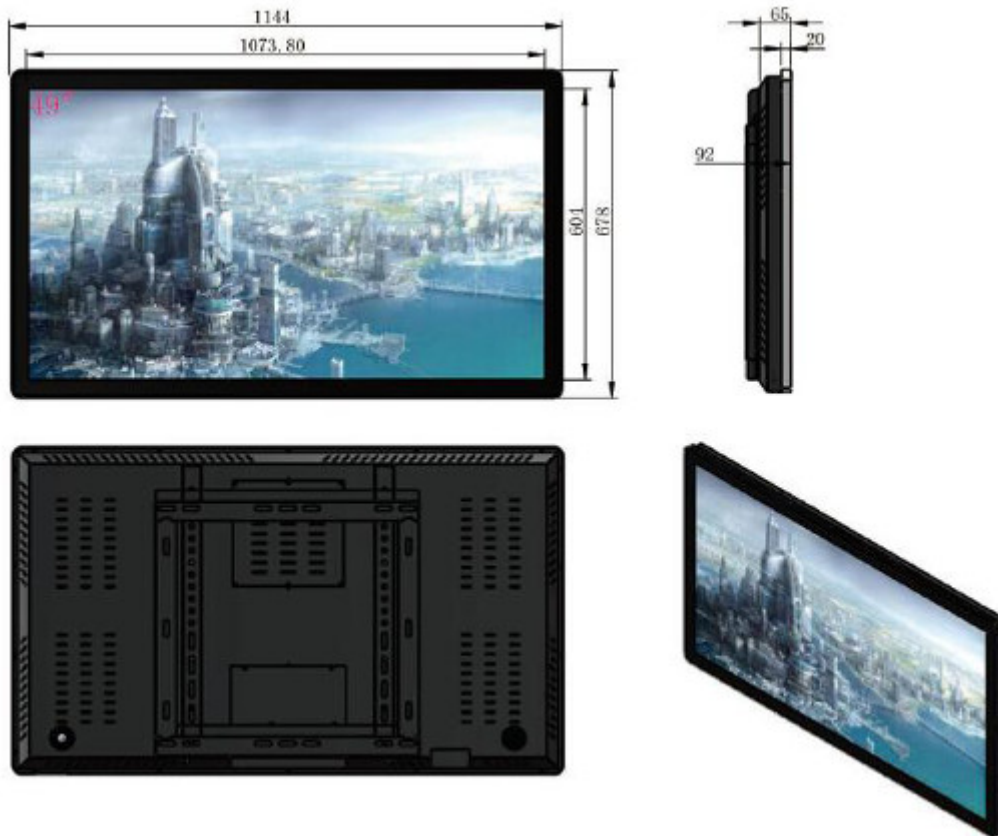

### Multi-Touch

Digital Signage has been equipped with a 10-point, high-capacity multitasking capacitive screen. The image on the capacitive screens is well visible both indoors and outdoors. Particularly noteworthy here is the precision of touch identification by the system, because it is at a very high level, although much depends on the materials used in the construction of the screen. In addition, tactile information monitors can be used to interact with the customer.



## Capacitive Touch

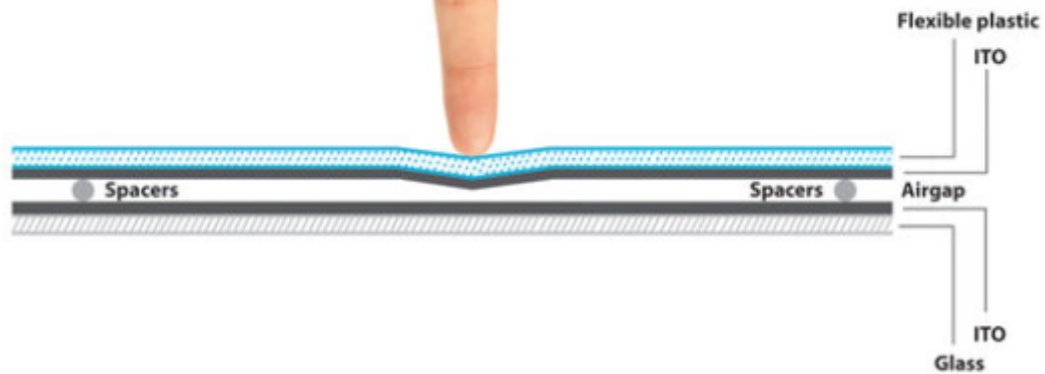

Digital Signage from this series can also be optionally also equipped with an infrared optical screen. Touch screens of this type do not require the screen to be covered by any special layer, instead, the LEDs emitting infrared light are mounted on the two edges of the screen, the bundles of which make up the net. It is then detected by sensors located on the remaining edges. The inclusion of some material in the display disrupts the transmission of infrared rays at a given location, allowing for a precise point of contact. Optical screens support multi touch and allow you to operate not only your finger, but also with a stylus, for example.

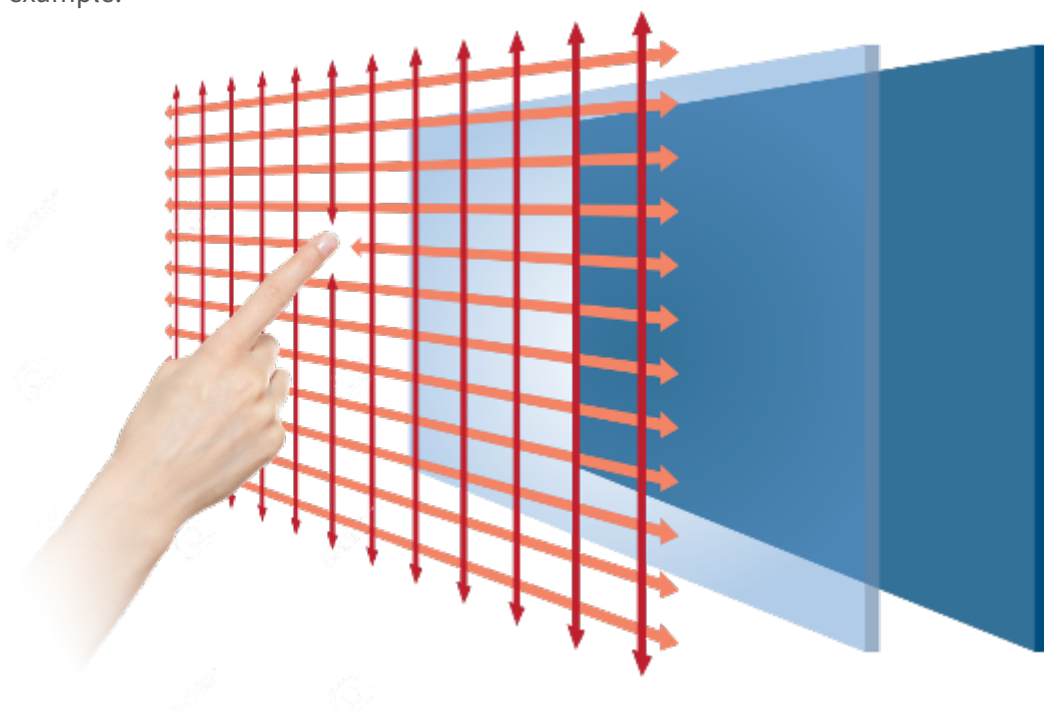

## Content Management

Optional the manufacturer also provides specialized software for remote management of display content on monitors. With this solution, you can control and update content on all monitors connected to the network (Wi-Fi, RJ-45 LAN or 3G) with a single PC. The software also allows you to modify the display layout so you can view multiple components at once. Content management is done using the convenient and intuitive drag and drop interface, Digital Signage automatically detects new content and starts playing it.

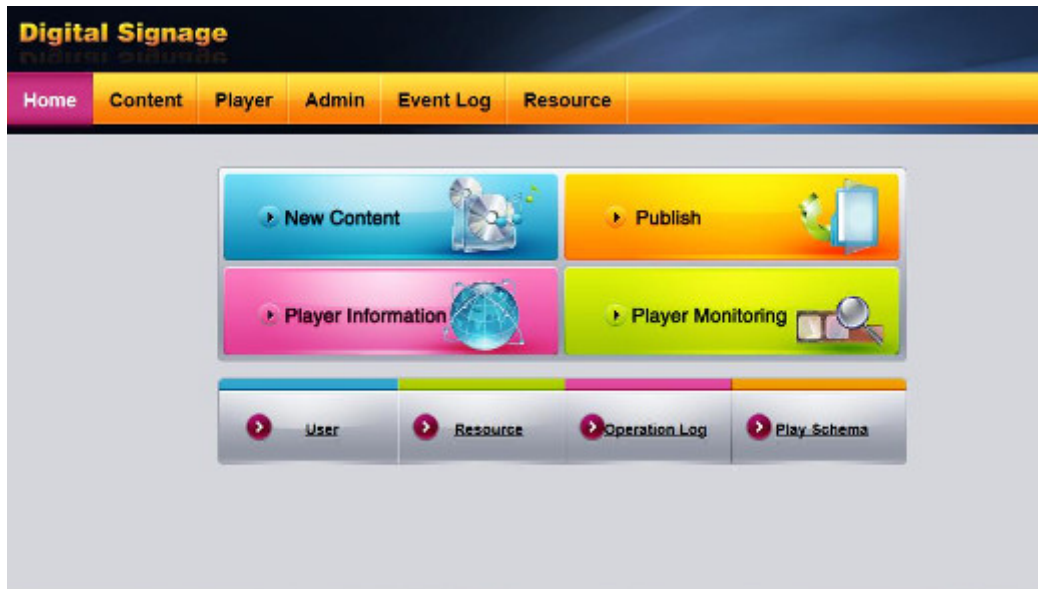

## Features

- ▷ DISPLAY CONTENT VERTICALLY OR HORIZONTALLY
- ▶ BUILT-IN CLOCK - AUTOMATICALLY SYNCHRONIZES TIME FROM THE NETWORK
  - ▷ YOU CAN PROGRAM THE PLAYBACK TIME
    - ▶ AUTOMATIC LOOP PLAY
- ▷ SUPPORTS: VIDEO (FULL HD), MUSIC, PICTURES, TEXT FILES, MICROSOFT OFFICE (PP, EXCEL, WORD), PDF, WEB PAGES, RSS, FLASH
  - ▶ REMOTE CONTROL USING SERVER.
- ▷ SCREEN SPLITTING - DISPLAY MOVIE, LOGOS, DATE, WEATHER, SUBTITLES, ETC. SIMULTANEOUSLY
  - ▶ AUTOMATIC MEDIA PLAYBACK
- ▷ REMOTE MANAGEMENT AND UPDATING OF CONTENT IN REAL TIME
- ▶ UPDATE THE CONTENTS OF THE BUILT-IN MEMORY VIA THE USB INPUT

## COMMUNICATION

[go top...](#)

Digital Singage Player - The MobiPad HDY490W comes standard with Wi-Fi wireless communication. The device also has a built-in Bluetooth module. Optionally, Digital Signage can be equipped with a 3G module.



Connector Type	Quantity
Mini USB	1
USB 2.0	2
RJ-45	1
Slot SD	1
HDMI	1
AC	1

## AVAILABLE VERSIONS

[go top...](#)

Choose the version that fits your needs. By clicking on the hardware configuration number you will be redirected to the product with the parameters listed below. On request we may create a configuration not available on offer. Detailed parameters are available in the "Technical Data" tab.

	<b>3G</b>	<b>2 Years warranty</b>	<b>Touch type</b>
<b>HDY490W</b>			Capacitive
<b>HDY490W-2Y</b>			Capacitive
<b>HDY490W-IR</b>			Optical
<b>HDY490W-IR-2Y</b>			Optical
<b>HDY490W-IR-3G</b>			Optical
<b>HDY490WIR-3G-2Y</b>			Optical
<b>HDY490W-3G</b>			Capacitive
<b>HDY490W-3G-2Y</b>			Capacitive

## APPLICATION

[go top...](#)

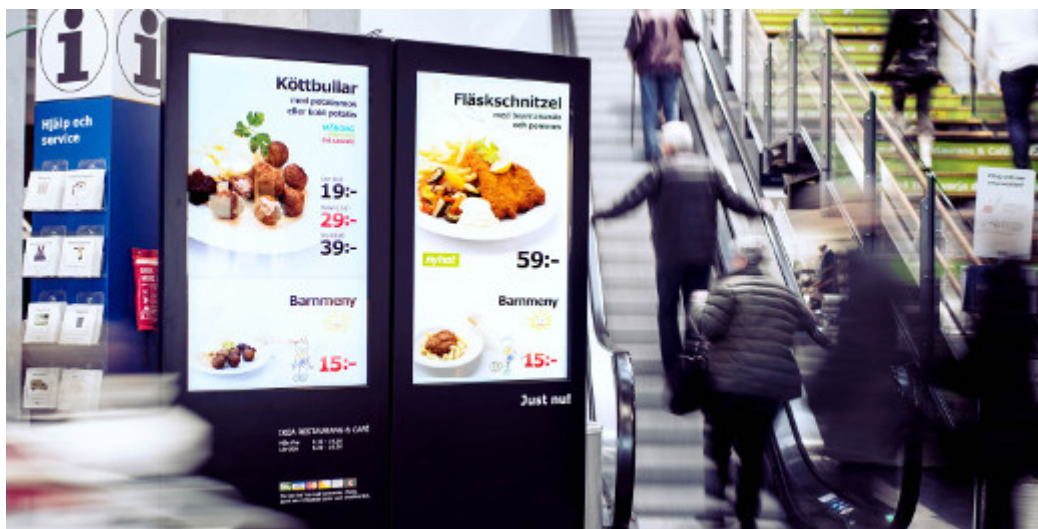

Digital Signage is a modern, dynamic form of advertising that allows you to stand out from the competition and raise interest among your audience. This solution allows you to remotely control your monitor network with one central device. In addition, it is possible to integrate such device with the company's database applications, which allows for full automation of displayed messages, thanks to this solution the receiver always has access to up-to-date data. Despite being a relatively new form of information transfer, Digital Signage is slowly but effectively supplanting older, static forms of advertising such as posters, banners, banners and leaflets.

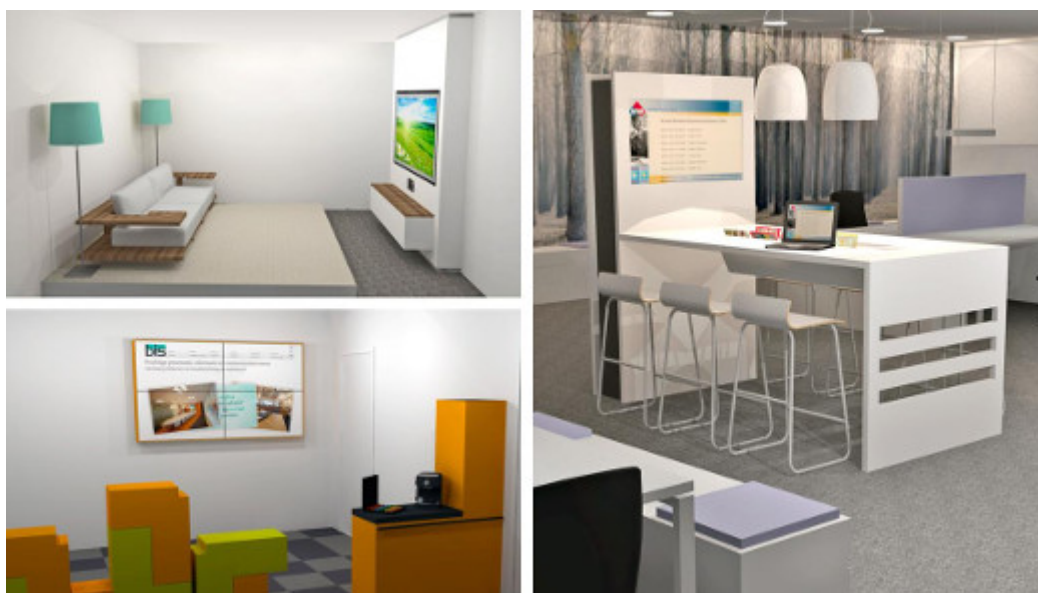

Digital Signage comes in many different forms and can be used for almost any purpose. Advertising monitors can be found in places such as airports, shops, hotels, service centers, shopping malls, train stations, tourist offices and other smaller or larger companies, both indoor and outdoor. Wherever used, they will surely attract the attention of the customer, they will bring to your business the atmosphere of modernity and originality and will make them stand out among the competition.



Thanks to its versatility, Digital Signage can be easily adapted to any type of business. Examples of places and ways of using such systems are:

### **Trade and services**

The commercial industry is the mainstay of this type of device, Digital Signage can be used here to present prices, products, branding, promotion information, or traffic to the selected product. For tactile interaction, you can also use tactile infokios.

### **Hotel and gastronomy**

In this type of place Digital Signage can serve not only for commercial purposes but also for information such as menu presentation, promotion of services, information on available rooms, booking rooms, etc.

### **Industry**

In industry-related areas, DS panels can display order tables, production information, employee information, and device monitoring. Touch Digital Signage can be used to organize interim Fire protection tests, health and safety, etc.

### **Offices and institutions**

Here, just as in the industry, DS systems are primarily information functions, can display messages, notices, but also present announcements (eg job offers) or even

help customers.

## **Education**

Digital Signage places a modern information network displaying information such as room listings, lesson plans, conference listings, and reminders of important events.