



Notebook - Clevo P150EM v.2

Category:	CLEVO Powerful Notebooks
Manufacturer:	Clevo
WAN:	No - optional yes
WLAN:	Tak - Combo Card (BT+Wireless LAN 802.11B/G/N)
Bluetooth:	Yes - Bluetooth v3.0
Processor:	Intel®Core™ i5-3210M processor (2.5 - 3,1 GHz Turbo, 3MB L3 Cache, HD 4000, 22nm, 35W, IVY BRIDGE)
Memory:	4GB SODIMM DDR3 204Pin 1600MHz Kingston
Chipset:	Mobile Intel®HM77 Express Chipset
Display:	T15'6 FHD/GT (1920'1080) 16:9 Widescreen MATT
Graphics card:	Nvidia Geforce GTX-670MX (N13E-GR) 3GB
Touch screen:	No
Swivel Hinge:	No
Hard Drive:	HDD 500 GB WD SCORPIO BLACK 7200 RPM, 16MB cache
BIOS:	-----
VGA out:	Yes - HDMI , Display Port
LAN:	10/100/1000MB Base-TX Ethernet LAN

Camera:	Yes - 2.0 FHD Mpx
Audio:	Yes: External 7.1CH audio output supported by headphone, microphone, Line-in, and S/PDIF jack
Security:	Kensington Lock, Fingerprint security
TV Out:	HDMI + Display Port
In/Out:	3x USB 2.0 ports, 1x USB 3.0 port, 1x e-SATA port, 1x IEEE 1394a port, 1x DVI-I out port, 1x HDMI output port, 1x Headphone jack, 1x Microphone jack, 1x S/PDIF output jack, 1x Line-in jack, 1x RJ-11 MODEM port, 1x RJ-45 LAN port, 1x DC-in jack
Keyboard:	QWERTY - function keys,illuminated
Additional Navigation Devices :	Touch pad with scrolling function
Battery:	Li-ion / 8 Cells / 5200mAh - 76.96Wh
Working time on battery:	360 min
Size:	376(W) x 256(D) x 35~43(H) mm / 3,1 kg including ODD and Battery
CD/DVD:	DVD DUAL Super Multi
Operating System:	----
Flash Card Reader:	Yes - 9-in-1 (MMC/RSMMC, SD/mini SD/SDHC/SDXC, MS/MS Pro/MS Duo)
GPS:	No
TV Tuner:	No
Color:	Black
Other:	----

Product from the Archive - production finished



Founded in 1983, **CLEVO** has achieved a fine reputation as a developer and manufacturer of notebook computers. Due to our product positioning in the high-tech market, Clevo has won many awards in computer product evaluation conducted throughout the world.





The **ProStar P150EM Gaming Laptop** provides jaw-dropping visuals that will impress even the most critical users by utilizing the world's fastest notebook GPU – the NVIDIA GeForce GTX 675M. The unit brings notebook gaming closer to a cinema quality effect by combining the power of DirectX 11 and accelerated NVIDIA PhysX technology. The NVIDIA CUDA technology unlocks the power of the CPU's processor cores to accelerate the performance for even the most

demanding system tasks such as video transcoding. The **ProStar P150EM Gaming Laptop** lets you play games the way they're meant to be played without having to worry if your video card is up to the task.



With intelligent performance that accelerates in response to demanding tasks, such as playing games and editing photos, the Intel® Core™ i5 third generation processor moves faster when you do.

The Intel® Core™ i5™ processor automatically allocates processing power where it's needed most. Whether you're creating HD video, composing digital music, editing photos or playing the coolest PC games — with the Intel® Core™ i5 processor you can multitask with ease and be more productive than ever.

Semiconductor LED backlit display (LED, Light-Emitting Diodes) ensures an even and uniform light across the screen. LED backlighting offers many advantages: low operating voltage, therefore low energy consumption and prolongs battery life, precise control of light intensity, longer than traditional displays of component life, finally – not less important – protecting the environment.



Wide Screen display is a very important feature. Wide Screen makes the display look bigger. The 16:9 aspect ratio is the most popular. Movie theaters and high end home televisions all display in 16:9 wide screen ratio just like these do. This has a backlit display for extra brightness. The monitor will look good during day or night. You can adjust all the color and picture settings (color, contrast, brightness, etc).

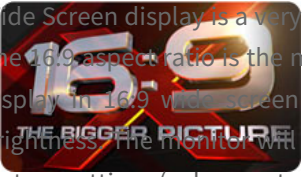

[go top...](#)

Enjoy a dramatic boost in multitasking performance with more system memory thanks to the quad SODIMM memory slots. With up to 32GB of Dual-Channel DDR3 memory, your system will never lag while multimedia editing, graphics design/3D modeling, and graphic-intensive gaming at once.

FOUR
DDR3
MEMORY
MODULES
CAPABLE

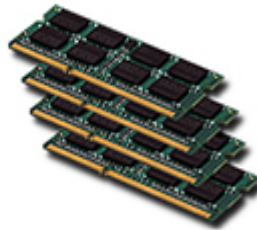

NVIDIA GeForce GTX 680M

NVIDIA® GeForce® GTX 680M to najszybszy i najbardziej zaawansowany układ GPU do notebooków dla graczy jaki dotąd skonstruowano.



[mobilator.pl](#)

The NVIDIA GeForce GTX 670M leverages NVIDIA's revolutionary new architecture to deliver up to 60% more performance than the previous generation*. Built for speed and efficiency, the GeForce® GTX 670M GPU outpaces the competition by up to 30%*. Plus, NVIDIA GeForce™ drivers ensure that you're always getting the most out of your GPU for the ultimate gaming experience.



[go top...](#)



NVIDIA® CUDA™ technology unlocks the power of the GPU's processor cores to accelerate the performance for even the most demanding system tasks such as video transcoding. The HM lets you play games the way they're meant to be played without having to worry if your video card is up to the task.

NVIDIA® Optimus™ technology intelligently optimizes your notebook PC, providing the outstanding graphics performance you need, when you need it, all the while extending battery life for longer enjoyment.



NVIDIA PhysX™ technology helps games play better and feel better by making interaction with environments and characters far more realistic than ever before. By making behavior more realistic, the graphics look and “feel” better. PhysX is designed specifically for hardware acceleration by powerful processors with hundreds of processing cores. Because of this design choice, NVIDIA GeForce GPUs provide a dramatic increase in physics processing power, and take gaming to a new level delivering rich, immersive physical gaming environments with features such as:



- Explosions that create dust and collateral debris
- Characters with complex, jointed geometries, for more life-like motion and interaction
- Spectacular new weapons with incredible effects
- Cloth that drapes and tears naturally
- Dense smoke & fog that billow around objects in motion



DirectX 11 GPU with Shader Model 5.0 support designed for ultra high performance in the new API's key graphics feature, GPU-accelerated tessellation.

Secure Login

Fingerprint in the knowledge your system is protected by the most advanced methods possible. The Sage™ NP9150 (Clevo P150EM) utilizes a fingerprint reader for added security and easy log in with a simple finger swipe.



www.mobilator.pl

NVIDIA® company CLEVO leaving the needs of laptop users comply P150 easy access to system components. In this way without any problems replacing the drive with a larger one, increase the efficiency of bone RAM or simply przeczyścisz laptop with residual dust.

[go top...](#)



Inside the laptop are two disk made in Flash SSD (Solid State Disc) technology. This means that they has no moving parts inside. Disk reads and writes data 2 times faster than standard 2,5" disks. In addition, it does not heat up at all, consuming little energy and discharge CPU up to 10%. Computer witch SSD drives runs much faster.

Laptop is also equipped with third ultra-fast SSD disk using mSATA connector. In addition, to the computer can be connected another devices via an external eSATA connector.



The CLEVO P150EM is equipped with the latest USB 3.0 technology that can deliver transfer speed up to 10 times faster than USB 2.0. This allows faster transfer of HD content. USB charging is also faster - port provides a 900mA current, offering power saving features by switching to standby mode on unused devices, or turning them off.

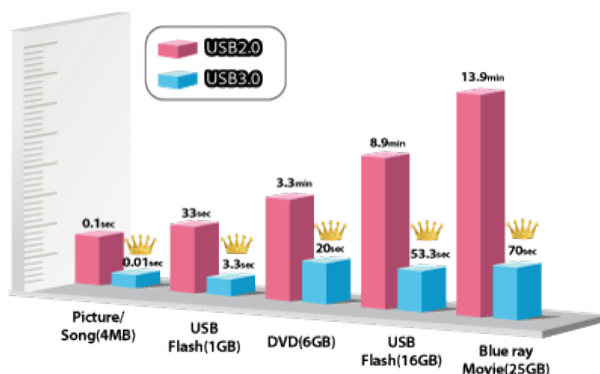
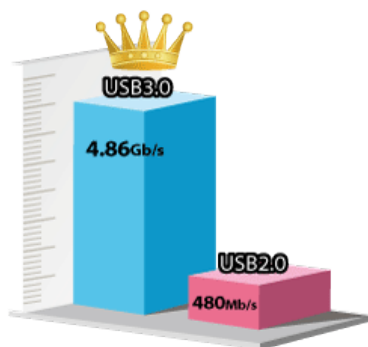

[go top...](#)

Make your p150em a stylish focal point with the full color programmable backlight keyboard. Choose from 7 instant effects or customize your own color combinations in 3 different keyboard sections with the Keyboard Backlight Application.



[go top...](#)



- | | |
|--------------------------|--------------------------------|
| 1. Power button | 5. Built-In Microphone |
| 2. Led status indicators | 6. TouchPad with Scroll-Slider |
| 3. Onkyo Speakers | 7. Fingerprint Reader |
| 4. Illuminated Keyboard | |

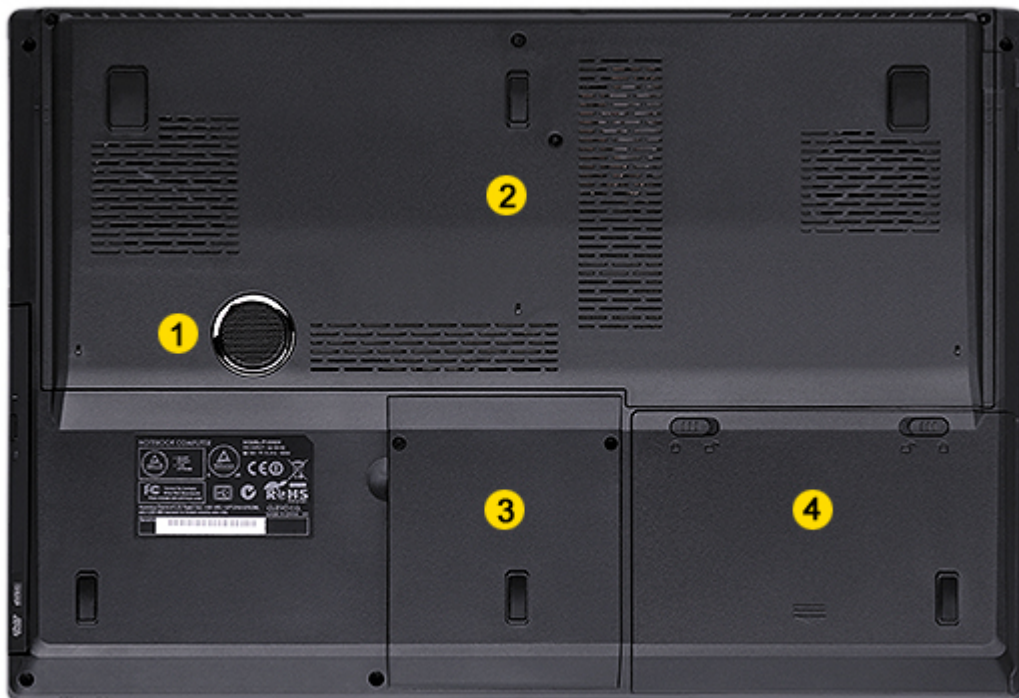

- | | |
|---|---------------------------|
| 1. Subwoofer | 3. Hard Drive Compartment |
| 2. CPU/GPU/mSata SSD/Pamięć/Compartment | 4. Battery pack |



- | | |
|---|--------------------------------|
| 1. Mini I-EEE-1394a Port | 4. e-Sata Port (USB 3.0 Combo) |
| 2. RJ-45 LAN Port (Gigabit) | 5. 9-in-1 Card Reader |
| 3. 2 USB 3.0 Ports (1x Powered USB Port, AC/DC) | |



1. Power Status Indicators



- | | |
|-----------------------|--------------------|
| 1. Optical Device Bay | 5. Line-in Jack |
| 2. Headphone-Out Jack | 6. USB 2.0 |
| 3. Microphone-In Jack | 7. Kensington Lock |
| 4. S/PDIF-Out Jack | |

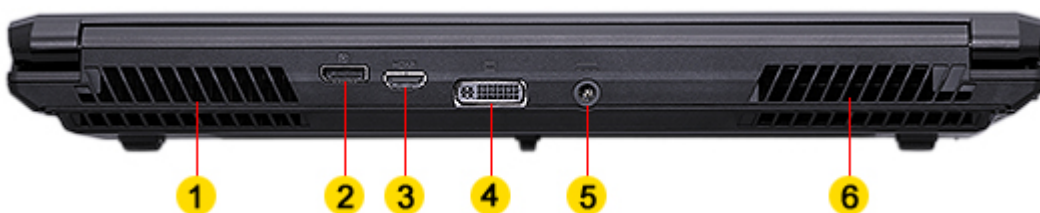

- | | |
|--------------|---------------|
| 1. GPU Vents | 5. DC-In Jack |
|--------------|---------------|

2. Display Port 1.1 Output Jack

6. CPU Vents

3. HDMI 1.4a Output Jack

4. DVI-I Output Jack

[go top...](#)



The integrated multi-gesture touchpad on the notebook allows user to perform various operations by tapping multiple fingers and making gestures. When using a computer touchpad can accurately detect multi-finger movements. Using touchpad is not only effective but also enjoyable.

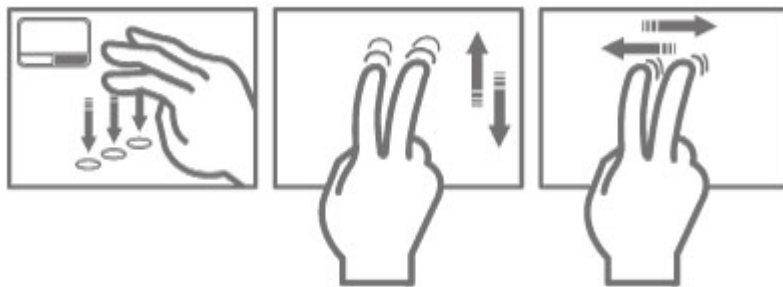

No more cable connections! Thanks to the bluetooth® 3.0 technology that allows the exchange of information among different devices, you can easily use all the accessories of the Clevo line (and more) with an in-built special software. Bluetooth 3.0 is much more faster than previous versions of this interface.



The great expansion of WiFi technologies to wireless connect to the Internet both in professional and domestic settings through the public or private hot-spots, make your Clevo inseparable resource for your daily activities. New "n" standard provides great transfer up to 150Mbit/s. This feature allows you to download and upload data in short period of time.



Enter the world of online communication and take advantage of the built-in video camera to participate in a video conference or simply chat with your friends face-to-face no matter how far apart you may be. Thanks to the 2.0 megapixel high-resolution camera, your video will have never looked so real.



CLEVO P150 takes mobile entertainment to the next level! The fastest notebook with 17.3" screen made until now. P150EM offers newest third generation Intel Core i5 mobile processors and one of the best nVidia GeForce graphic card - GTX 680M.



The advertisement features a central image of a CLEVO P150 laptop. To the left is a stylized illustration of a mobster in a top hat and trench coat, holding a cigar, with a cityscape in the background. Above the laptop is the CLEVO logo and a Batman logo. To the right of the laptop are the NVIDIA GeForce logo with the slogan "GEAR UP. GAME ON. GEFORCE GT" and the NVIDIA Optimus Technology logo. The website address "www.mobilator.pl" is visible in the bottom left corner of the image area.

[go top...](#)